

Flexible Line Section 3 1/8" EIA || BN 921814

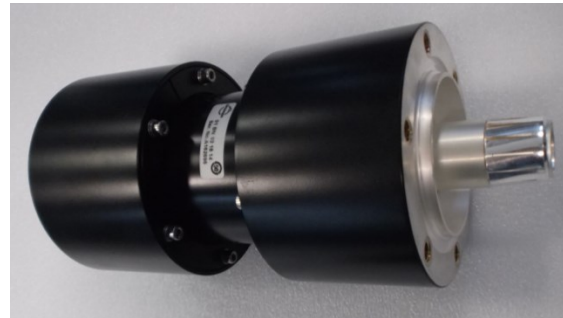

Interface type	3 1/8" EIA (50 Ω) per IEC 60339 with fixed coupling elements on both ends
Frequency range	DC to 1600 MHz
VSWR, max.	1.06 DC to 900 MHz 1.14 below 1600 MHz
Average power capability, max.	11 kW @ 1600 MHz 15 kW @ 860 MHz 29 kW @ 230 MHz 44 kW @ 100 MHz
Proof voltage, max.	14 kV
Attenuation, max.	0.05 dB @ 1600 MHz
Length	230 mm
Length variation, max.	+/- 5 mm
Displacement of flange axes, max.	4 mm
Inclination of flange axes, max.	4°
Inner conductor material / surface finish	copper alloy / silver plated
Outer conductor material / surface finish	copper alloy / silver plated
Case material / surface finish	copper alloy / painted black (RAL9005 black)
Insulation	PTFE
IP protection level	IP40 per EN 60529
Weight, approx.	12.5 kg
Environmental conditions	See „Environmental Conditions for Broadcast Products“ TD-00060
Relative humidity, max.	95% (non-condensing)
Operating position	any
Scope of delivery	protective bag, plastic box

Flexible Line Section 3 1/8" EIA || BN 921814

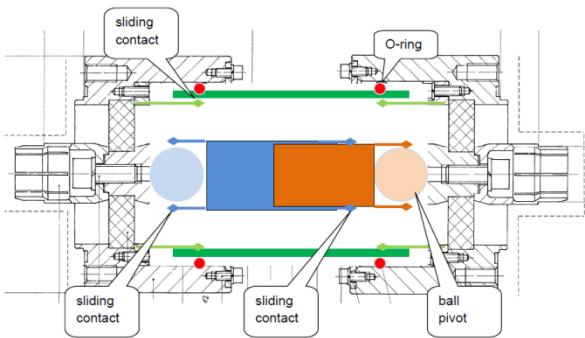
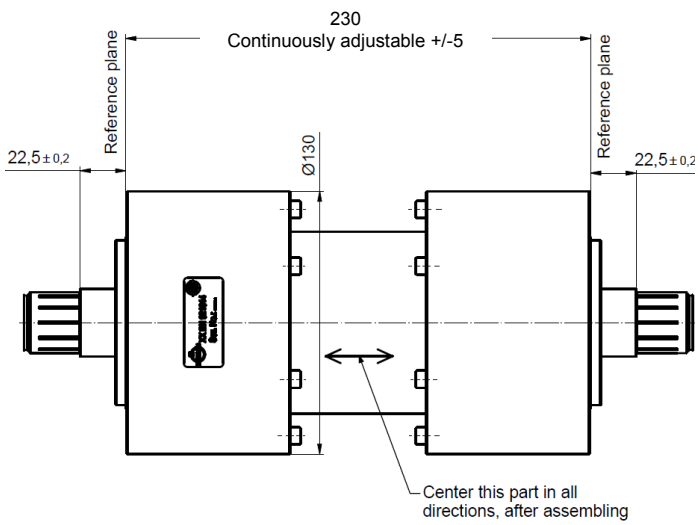

Remarks:

- 1) Admissible mismatch of the flanges: 4 mm
- 2) Admissible angle between the flanges: 4°

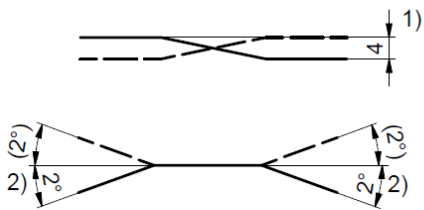

Typical curve

