

Single-Channel Rotary Joint || BN 529013

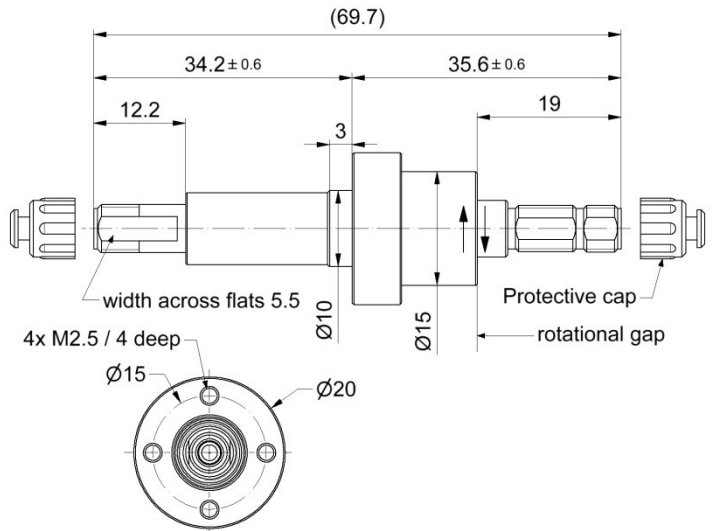

all dimensions in millimeter

Application note:

TD-00021

Fiber optic channel characteristics

Interface type / material	F-SMA-f / stainless steel
Fiber type	Multimode G50 / 125 μm
Wavelength	850 nm to 1550 nm
Average power capability, max.	10 mW / 10 dBm
Insertion loss, max.	2.0 dB
Insertion loss variation over rotation, max.	0.5 dB

Single-Channel Rotary Joint || BN 529013

Mechanical data

Rotating speed, max. / nominal	3000 rpm / 2000 rpm
Life, min.	200 x 10 ⁶ revolutions
Torque (room temperature), max.	0.03 Nm @ rotation
Interface loads, max.	±5 N in axial direction ±5 N in radial direction
Case material	stainless steel
Case surface finish	no finish
IP protection level	IP63 per EN 60529 (all interfaces connected with appropriate gaskets)
Weight, approx.	0.1 kg
Marking	laser engraving

Environmental conditions

Operation	
Ambient temperature range	-40 °C to +85 °C
Relative humidity, max.	95% (non-condensing)
Storage	
Ambient temperature range	-40 °C to +85 °C
Relative humidity, max.	95% (non-condensing)