

Waveguide to Coaxial Adapter || BN 533141C0001

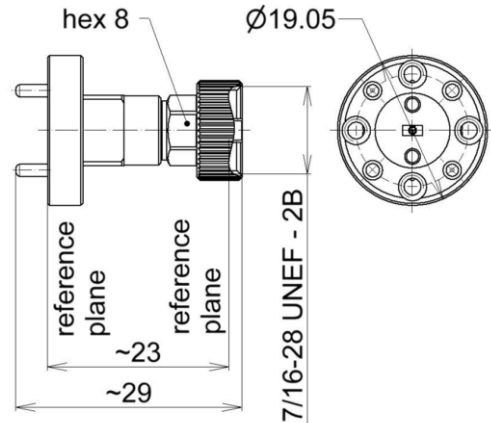

all dimensions in millimeter

**Technical characteristics**

Waveguide interface aperture	R 900 per IEC 60153-2 (WR 10 per EIA RS-261, WM-2540 per IEEE Std 1785.1)
Waveguide interface connector	UFC 900 per IEC 60154-2; compatible to M3922/67-010 (UG-387/U-mod) and IEEE 1785-2a type flanges
Coaxial interface type	1.0 mm socket per IEC 61169-31 (50 Ω) ruggedized by enlarged thread
Frequency range	75 to 110 GHz (W band)
Return loss, min. / typ.	16 dB / 20 dB
Insertion loss, max. / typ.	0.8 dB / 0.6 dB
Housing material / surface finish	beryllium copper / gold plated copper alloy / gold plated
Inner conductor material / surface finish	beryllium copper, age hardened / gold plated
Other metal parts material / surface finish	stainless steel / passivated
Weight, approx.	0.02 kg
Marking	laser engraving

**Environmental conditions**

<b>Operation</b>	
Ambient temperature range	+18 to +28°C
Relative humidity, max.	95% (non-condensing)
<b>Storage</b>	
Ambient temperature range	-40 to +70°C
Relative humidity, max.	95% (non-condensing)

**Scope of delivery and accessories**

Scope of delivery	data sheet, handling instructions, protective caps, socket-head cap screws no. 4-40 UNC
-------------------	--

This document is proprietary to us. All rights reserved. Any use, transfer, or reproduction of this document or the know-how contained therein requires our express consent.

Template TD-00002Y

# Waveguide to Coaxial Adapter || BN 533141C0001

## Typical return loss response

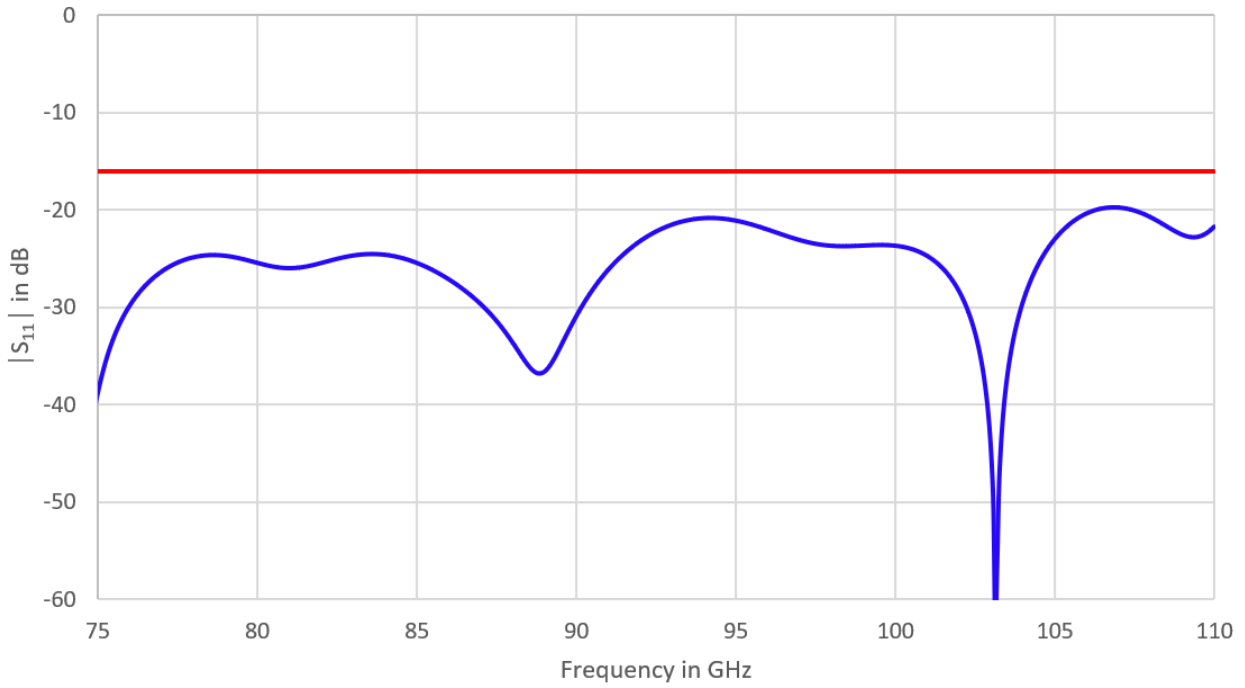

## Typical insertion loss response

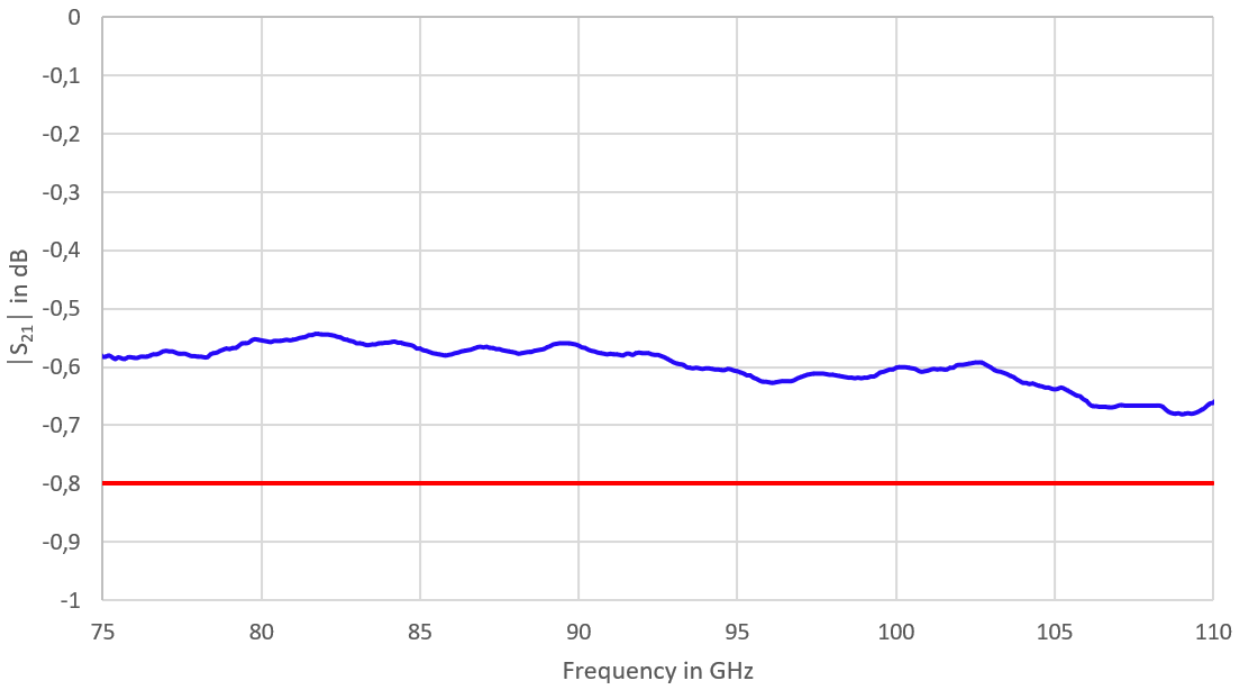

This document is proprietary to us. All rights reserved. Any use, transfer, or reproduction of this document or the know-how contained therein requires our express consent.

Template TD-00002Y