

6 1/8" EIA Coupling Element || BN 540084C0001

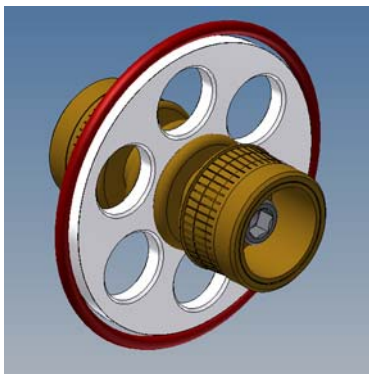

Interface type	EIA 6 1/8" male – 50 ohms	
Standards	EN 122150; 339 ICE (except retention force gauge)	
Frequency range *)	0 to 350 MHz	
Average power, max. **)	100 MHz 230 MHz 350 MHz 800 MHz	224 kW 148 kW 120 kW 78 kW
VSWR, max. *)	100 MHz 230 MHz 350 MHz 800 MHz	≤ 1.05 ≤ 1.06 ≤ 1.08 ≤ 1.10
Proof voltage *)	28 kV @ sea level (NN) 47 kV @ 2 bar absolute 61 kV @ 4 bar absolute	
Inner conductor material / surface finish	copper alloy / silver plated	
Outer conductor material / surface finish	n.a.	
Insulation	AL2O3 (acc. to EN 60672) (for use in ionizing radiation environment)	
Sealing	silicone	
Other metal parts	stainless steel	
Absolute operating pressure *)	4x10 ⁵ Pa (4 bar)	
Pressurized by	SF ₆ , N ₂ or Air (dry)	
Leakage rate, max. *)	5x10 ⁻⁴ mbar l/s @ absolute operating pressure	
Admissible axial force	acc. to EN 122150	
Axial plug in force, max.	60 N (reduced retention force gauge of EN 122150)	
Weight, approx.	2.3 kg	
Environmental conditions	For limitations see "Environmental Conditions for Broadcast Products" TD-00060	
Scope of delivery	Coupling element, sealing and 12x (screws M10x60 DIN 912 and nuts M10 DIN 934)	

Conditions:

*) With an appropriate outer conductor

**) At 40°C ambient temperature; 1 bar inner absolute air pressure; inner conductor temperature 150°C