

9 3/16" Coupling Element || BN 540972

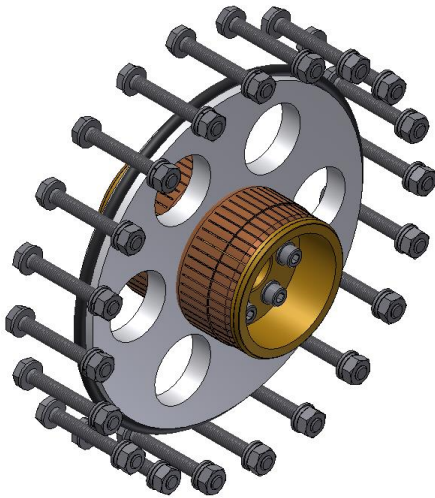

(picture similar)

Radio frequency characteristics

Interface type	EIA 9 3/16" male
Frequency range	0 to 350 MHz
Average power capability, max.	see attached diagram*
VSWR, max.	1.02 up to 120 MHz 1.05 up to 350 MHz
Working voltage	25 kV @ sea level 50 kV @ 3 bar absolute

* Conditions: - Waveguide pressurized with dry air or N₂ at pressure according attached diagram

General mechanical data

Material	copper alloy, stainless steel, silicone, PTFE
Material, insulation	PTFE
Weight, max.	5.4 kg
Marking	adhesive label on packing

General environmental conditions

Operation	
Ambient temperature range	+10 to +50 °C
Relative humidity, max.	95% (condensation not permitted)
IP protection level	IP64 per EN 60529 (all interfaces connected with appropriate gaskets)
Storage	
Ambient temperature range	-20 to +50°C
Relative humidity, max.	95% (condensation not permitted)

Template TD-00002G

9 3/16" Coupling Element || BN 540972

Power rating and attenuation for Coupling Element 9 3/16"

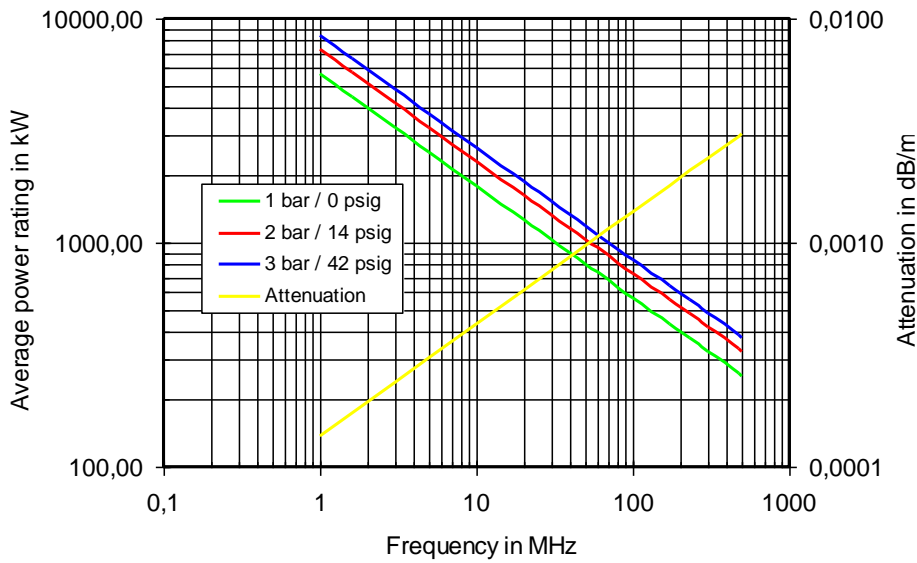

The curves are based on an ambient temperature of 40°C and a maximum inner conductor temperature of 150°C

Outline and dimensions (drawing similar)

