

Inter-Series Adaptor Push-Pull Plug - Socket || BN 432061

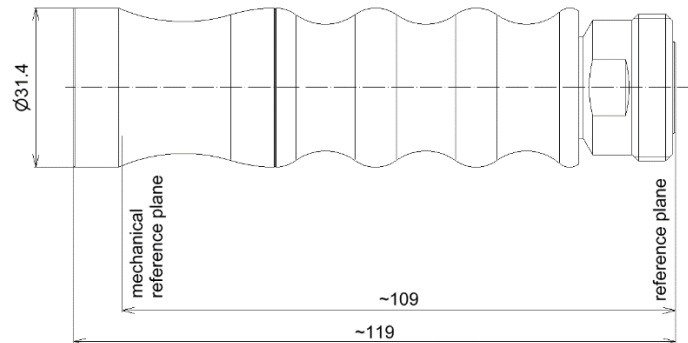

picture similar



all dimensions in millimeter

Radio frequency characteristics

Interface type	4.3-10 plug per IEC 61169-54 7-16 socket per IEC 61169-4
Frequency range	DC to 6 GHz
Impedance	50 Ω
VSWR, max.	1.02 @ DC to 2 GHz 1.06 @ 2 to 6 GHz
Intermodulation (IM3) 2x20 W max.	-165 dBc (for first 5,000 ¹⁾ matings)

Mechanical characteristics

Matings	10,000 ¹⁾	
Center conductor material / surface finish	DUT interface	Rear interface
	CuBe age hardened / gold-plated	copper alloy / silver-plated
Outer conductor material / surface finish	DUT interface	Rear interface
	copper alloy / gold plated	copper alloy / silver-plated
Other metallic parts / surface finish	CuBe, copper alloy / nickel-plated	
Insulation	LCP PTFE	
Latching	manual-locking	
Weight, approx.	290 g	

Environmental conditions

Ambient temperature range	+5 to +40 °C (indoor)
---------------------------	-----------------------

Applicable documents

Installation instructions	M36377
---------------------------	--------

1) In order to ensure best possible measurement result, cleaning has to be assessed and executed by professional staff on a regular basis.